

Instruction Manual

Hydraulic Drum Transporter

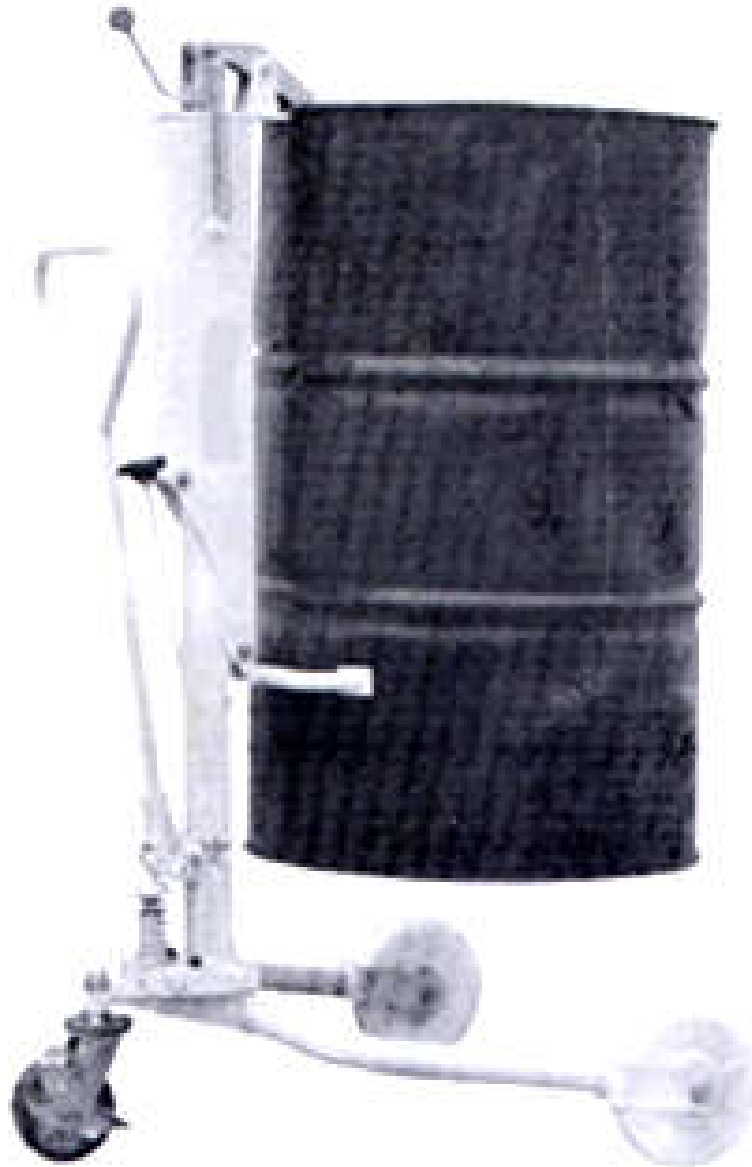

WARNING

THE MANUFACTURERS SHALL NOT BE HELD LIABLE IN CASE OF FAULTS OR ACCIDENTS DUE TO NEGLIGENCE, INCAPACITY, INSTALLATION BY UNQUALIFIED TECHNICIANS AND IMPROPER USE OF THE TRUCK.

DO NOT OPERATE THIS MACHINE UNTIL YOU READ AND UNDERSTAND ALL THE DANGERS, WARNINGS AND CAUTIONS IN THE MANUAL.

Summary

- I. Describing Structure and Relevant Parts
- II. Specifications
- III. Precaution
- IV. Operating Methods
- V. Maintenance
- VI. Assembly and Fixing

THANK YOU FOR CHOOSING OUR HYDRAULIC DRUM TRANSPORTER. PLEASE CAREFULLY READ THE MANUAL BEFORE USING IN ORDER TO ENSURE YOUR SAFETY AND CORRECT OPERATION.

NOTE: All of the information reported herein is based on data, which can be got at the time of printing. The factory reserves the right to improve its own products at any time without notice and without liability. It is therefore advisable to regularly check for any changes.

I . Describing Structure and Relevant Parts

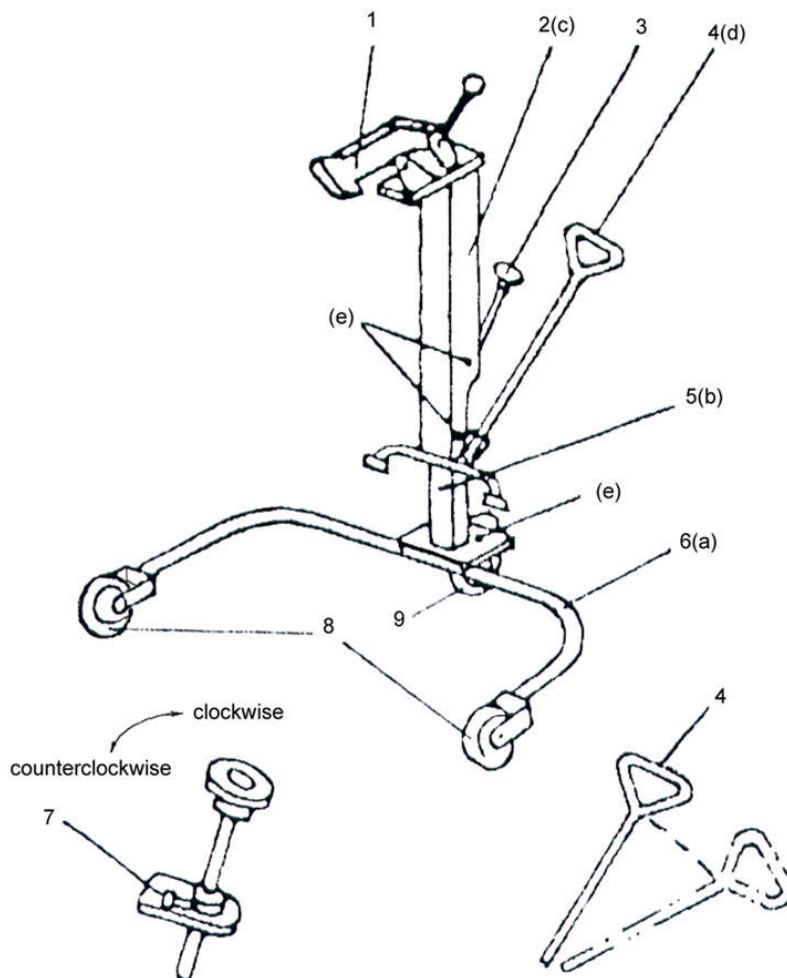

Item	Description	Remark
1	Clamp	
2	Lifting frame	
3	Joystick	
4	Handle	
5	Hydraulic cylinder	
6	Chassis	
7	Stop device	
8	Wheel	
9	Caster	

II. Specification

Lifting capability	250kg/550lbs
Lifting height	280mm/11"
Max.drum diameter	572mm/22.5"
Max.drum length	915mm/36"
Net weight	40kg/88lbs

III. Precaution

1. Always use the hydraulic drum transporter on firm and flat floor.
2. Don't overload
3. Only after clamp firmly biting drum can the transporter be moved.

IV. Operating Methods

1. Lifting drum

Turn joystick (Part No.3) clockwise, and then move the transporter in order to make the lifting frame (Part No.2) contact with drum.

Time after time press the handle (Part No.4) to pump up the lifting frame (Part No.2) so that the upper edge of drum is between the clamp's teeth and the teeth on the upper end of lifting frame (Part No.2). Please refer to the following figure.

Then push the bulbous knob that is connected to clamp (Part No.1) so as for the clamp



to bite the drum firmly and for the bulbous knob to lock the clamp (Part No.1).

Continue to pump up the lifting frame (Part No.2) by handle (Part No.4) and then the drum will be lifted.

2. transportation

Push or haul the handle (Part No.4) to move the transporter to the destination. (Certainly, if necessary, operator can turn the handle to change the transporter's moving direction.)

3. Put down the drum

Slowly turn joystick (Part No.3) counterclockwise and lower the drum till it stands on appointed place.

Take the bulbous knob back to unlock position so as to release the clamp.

V. Maintenance

1. Do routine check of chassis (Part No.6) and front wheels. Especially ensure that rear caster is firm.
2. Do routine check of packing.
3. It is feasible and reasonable to change hydraulic oil while change packing. It is suggested to use equivalent performance hydraulic oil.

Use different hydraulic oil according to temperature scale below

Temperature	Hydraulic Oil
-5°C—+45°C	L-HM68 Hydraulic Oil (equivalent to ISO VG68)
-15°C—-5°C	L-HM46 Hydraulic Oil (equivalent to ISO VG46)

4. Do routine check of the clamp's tooth. Replace it if tooth wears out seriously.
5. Do routine check of all the connecting parts for example pins and fasteners.

VI. Assembly and Fixing

Before assembly, some necessary tools must be prepared.

1. Take out all the subassemblies in following turns from the carton.

a	Chassis
b	Hydraulic cylinder
c	Lifting frame
d	Handle
e	Steel roller, pins, circlips and screws.

2. Fix hydraulic cylinder (b) on chassis (a) with screws (e).
3. Set lifting frame(c) on hydraulic cylinder (b) and then use steel roller, pin and circlips to fix them.
4. Assemble handle (d) on hydraulic cylinder (b) and fix them firmly.