

ECL 10/ECL 10M

Economic Power- Electric Stacker Compact and Reliable Design

INTRODUCTION

The ECL10M is an economic walkie-electric stacker, with rated capacity of 1000kg/2200lbs and lifting height from 1600mm/63inch to 3500mm/138inch.

The compact and light design is suitable for a variety low duty applications in warehouses .

ADVANTAGES

- Ideal solution for low-duty applications.
- Built- in charger for high autonomy.
- Battery discharge indicator with automatic lift cut-off function for higher battery lifetime.
- 4-wheel design with sideways tiller for high stability and perfect view.



Built-in charger
The built-in charger makes operations more autonomy and increases the operating range.

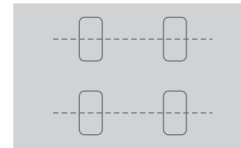

Stability
4-Wheel design with sideways tiller for excellent view and maneuverability as well as high stability.



Robust profile
Robust mast with real mast profiles for perfect stability, accuracy and high lifetime.



Powerful battery
2x12V 85Ah powerful VRLA-AGM main-tenance free batteries (option 2x12V 106Ah).



Battery deep discharge protection
Proofed and ergonomic emergency button and discharge indicator, more robust and reliable than other. The included automatic battery protection ensures high lifetime for the batteries.

Proofed components
Proofed components such as sensors, micro-switches, controller and hydraulic power- pack from international brands.

Fulfilling standards
Fulfilling the actual valid European standards, also in ISO 13849, performance level.

Applications
Ideal economic solution for all indoor low duty and occasional stacking operations.



Optional straddle leg
Adjustable straddle leg design, suitable for diverse pallet sizes and more stability.

Economic robust handle
Robust but economic handle with steel housing and plastic coating ensures reliable and comfortable operation.

Several masts
2 single mast versions(1600mm/63inch, 2000mm/78.7inch lift height) and one 2-stage duplex mast with 2900mm/114inch, 3200mm/126inch and 3500mm/138inch (All with perfect view through the mast). b5=686mm/27inch and straddle leg version optional. (b5=569mm/22.4inch standard).



Electric Stacker

Other type data

	Manufacturer's type designation		ECL1016	ECL1020	ECL1032	ECL1035	ECL1016 M	ECL1020 M	ECL1032M	ECL1035M
1.8	Load distance, centre of drive axle to fork	x(mm)	821		809		745		733	
2.1	Service weight	kg	430	450	525	540	676	696	771	786
2.2	Axle loading, laden front/rear	kg	550/890	560/890	590/935	600/940	736/940	756/940	796/975	406/980
2.3	Axle loading, unladen front/rear	kg	335/105	340/110	395/130	405/135	500/176	510/186	540/231	550/236
4.2	Lowered mast height	h1 (mm)	1950	2350	2100	2250	1935	2335	2085	2235
4.3	Free Lift height	h2 (mm)	1530	1930	70	70	1530	1930	70	70
4.4	Lift	h3 (mm)	1530	1930	3140	3440	1530	1930	3140	3440
4.5	Extended mast height	h4 (mm)	1950	2350	3625	3925	2120	2520	3720	4020
4.20	Length to face of forks	l2 (mm)	620		632		688		700	
4.33	Aisle width for pallets 1000X1200 crossways	Ast (mm)	2314		2318		2336		2341	
4.34	Aisle width for pallets 800X1200 lengthways	Ast (mm)	2242		2250		2290		2300	
6.6	Energy consumption acc. to VDI cycle	kWh/h	0.68		0.73		0.71		0.76	

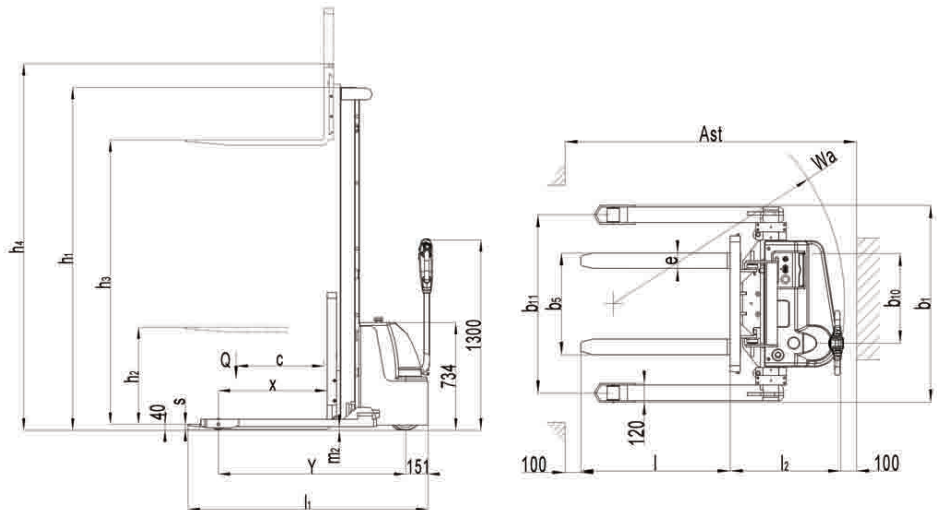

Type sheet for industrial truck acc. to VDI 2198 1KG=2.2LB 1INCH=25.4MM

	Manufacturer's type designation		ECL1029	ECL1029M
Distinguishing mark	1.2	Manufacturer's type designation		
	1.3	Drive	Battery	
	1.4	Operator type	Pedestrian	
	1.5	Load Capacity / rated load	Q (t)	1.0
	1.6	Load centre distance	C (mm)	600
	1.8	Load distance, centre of drive axle to fork	X (mm)	800
Weight	1.9	Wheelbase	Y (mm)	
	2.1	Service weight	kg	510
	2.2	Axle loading, laden front/rear	kg	580/930
Tyres, chassis	2.3	Axle loading, unladen front/rear	kg	385/125
	3.1	Tyres	Polyurethane (PU)	
	3.2	Tire size, front	Ø x w (mm)	220 x 70
	3.3	Tire size, rear	Ø x w (mm)	Ø80 x 93
	3.4	Additional wheels(dimensions)	Ø x w (mm)	Ø124 x 60
	3.5	Wheels, number front/rear(x=driven wheels)		1x+1 / 2
	3.6	Tread, front	b10 (mm)	529
Dimensions	3.7	Tread, rear	b11 (mm)	420/535
	4.2	Lowered mast height	h1 (mm)	1950
	4.3	Free Lift height	h2 (mm)	70
	4.4	Lift	h3 (mm)	2840
	4.5	Extended mast height	h4 (mm)	3325
	4.9	Height of tiller in drive position min./ max.	h14 (mm)	785/1300
	4.15	Height, lowered	h13 (mm)	85
	4.19	Overall length	l1 (mm)	1800
	4.20	Length to face of forks	l2 (mm)	632
	4.21	Overall width	b1 (mm)	800
	4.22	Fork dimensions	s/e/l (mm)	60/150/1150
	4.25	Distance between fork- arms	b5 (mm)	570/685
	4.32	Ground clearance, centre of wheelbase	m2 (mm)	29
	4.33	Aisle width for pallets 1000X1200 crossways	Ast (mm)	2318
	4.34	Aisle width for pallets 800X1200 lengthways	Ast (mm)	2250
Performance data	4.35	Turning radius	Wa (mm)	1485
	5.1	Travel speed, laden/ unladen	km/h	4.3/4.5
	5.2	Lift speed, laden/ unladen	m/s	0.11/0.16
	5.3	Lowering speed, laden/ unladen	m/s	0.13/0.11
	5.8	Max. gradeability, laden/ unladen	%	5/10
	5.10	Service brake		Electromagnetic
Electric- Motor	6.1	Drive motor rating S2 60min	kW	0.45
	6.2	Lift motor rating at S3 7.5%	kW	2.2
	6.3	Battery acc. to DIN 43531/ 35/ 36 A, B, C, no		no
	6.4	Battery voltage, nominal capacity K5	V/Ah	2X 12/ 85 ²⁾
	6.5	Battery weight	kg	2X 25
	6.6	Energy consumption acc. to VDI cycle	kWh/h	0.73
Additional data	8.1	Type of drive control	DC- Speed Control	
	8.4	Sound level at driver's ear acc. to EN 12053	dB(A)	< 70

For specifications of the other lifting heights, please refer to the other type data. 1) Optional:35/100/950 2) Optional:2x12V/106/Ah